

## FEATURES

- Size 30 CNOMO pilot adapted for the piloting of actuators or spool valves
- Version with M12 connection, integrated Led and protection
- Manual operator as standard

## GENERAL

Fluid	Air or neutral gaz, filtered, lubricated or not
Operating pressure	0 to 10 bar
Maximum allowable pressure	16 bar
Fluid temperature	-10°C to +60°C
Ambient temperature	-10°C to +60°C
Flow (Qv at 6 bar)	See "specifications"
Response time	5 ms
Base	ISO 15218 (CNOMO 06.05.80/NF E 49066, size 30)

## CONSTRUCTION

Body	PA + FV (glass filled polyamide 6/6)
Pad mounting body	Ports 1 and 2 on subbase, port 3 tapped M5
Exhaust	M5 female (NC function)
Seals	NBR (nitrile)
Electrical equipment	Conforming to NF C79300 standard

## ELECTRICAL CHARACTERISTICS

coil type		voltages		consumption		insulation class	protection degree	electrical connection
size 22	with pins	~	24V-48V-115V-230V/50Hz	inrush	hold	F	IP 65	spade plug size 22 connector, DIN 43650, 11 mm industry standard B
		=	24V-48V	6VA	3,5VA (2,5W)			
	M12 with Led and protection	=	24V	2,5W/3W (hot/cold)		F	IP 65	M12 connection, 3 pins CNOMO E03.62.520.N

## SPECIFICATIONS

orifice size (mm)	flow				allowable differential pressure (bar)		(M)	catalogue number		
	at 6 bar l/min (ANR)		coefficient Kv					with DIN connector	without DIN connector	with M12 connection
	1 → 2	2 → 3	1 → 2	2 → 3	min.	max.				
NC - Normally closed										
1,2	50	56	0,7	0,8	0	10	●	18900001	18900002	18900073
NO - Normally open										
1,2	40	50	0,6	0,7	0	6*	●	18900010	18900011	18900075

\*10 bar on request (with coil size 25)

(M) Type of manual operator : ● : maintained

## SUBBASES : see overleaf

## OPTIONS

### SOLENOID VALVE WITH COIL FOR DIN CONNECTOR

- Others voltages or 60 Hz frequency, on request
- Solenoid head EEx complying with European standards for explosive atmospheres "m" (PV), zones 1-21
- Solenoid head for dusty explosive atmospheres (DU), zone 22
- Solenoid head "CSA" approved
- Conformity to standard "UL", catalogue number: **612100**
- Exhaust port regulator ØM5 adaptable on port 3 - catalogue number: **34600380**
- Connector with cable outlet, 2m long: **88122413**
- Solenoid valve with built-in visual indicator and protection:

catalogue number solenoid valve without connector (see above)	+	catalogue number connector with built-in visual indicator and VDR protection			
		24V (~/=)	48V (~/=)	115V (~/=)	230V (~/=)
		<b>88122405</b>	<b>88122406</b>	<b>88122407</b>	<b>88122408</b>

### SOLENOID VALVE WITH M12 CONNECTION COIL

- Exhaust port regulator ØM5 adaptable on port 3 - catalogue number: **34600380**







OPTIONS

SOLENOID VALVE WITH COIL FOR DIN CONNECTOR

- Straight M12 connector with 5 female contacts, Ø4 to 6mm cable entry, catalogue number: **88100304**
- Straight M12 connector with 5 female contacts, Ø6 to 8mm cable entry, catalogue number: **88100256**
- Straight M12 connector with 5 female contacts, cable length 5m, catalogue number: **88130212**
- Right-angle M12 connector with 5 female contacts, cable length 5m, catalogue number: **88130213**

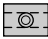
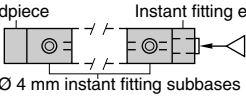
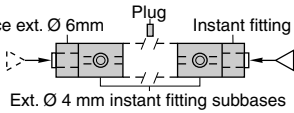
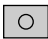
SUBBASES

connection	description	composition	catalogue number
with instant fittings (6/6 polyamide subbases)	1 single subbase		<b>35300069</b>
	1 joinable subbase		<b>35300070</b>
	set of 2 joinable end subbases, right-hand pressure intake, ext. Ø 6 mm instant fitting		<b>35300071</b>
	set of 2 joinable end subbases, right-hand and/or left-hand pressure intake, ext. Ø 6 mm instant fittings		<b>35300072 (1)</b>
G 1/8 tapped (Zinc diecast subbases)	1 laterally-connected single subbase		<b>35300047</b>
	1 laterally-connected joinable subbase		<b>35300048</b>

(1) Equipment can be used for 2 different pressure intakes.  
These subbases can be directly mounted on EN 50022 - AFNOR NF C63015 rail using 2 or more mounting clips (clips sold in packets of 10, cat no. **33400036**).

DIMENSIONS (mm), WEIGHTS (kg)

PAD MOUNTING SOLENOID VALVE ALONE

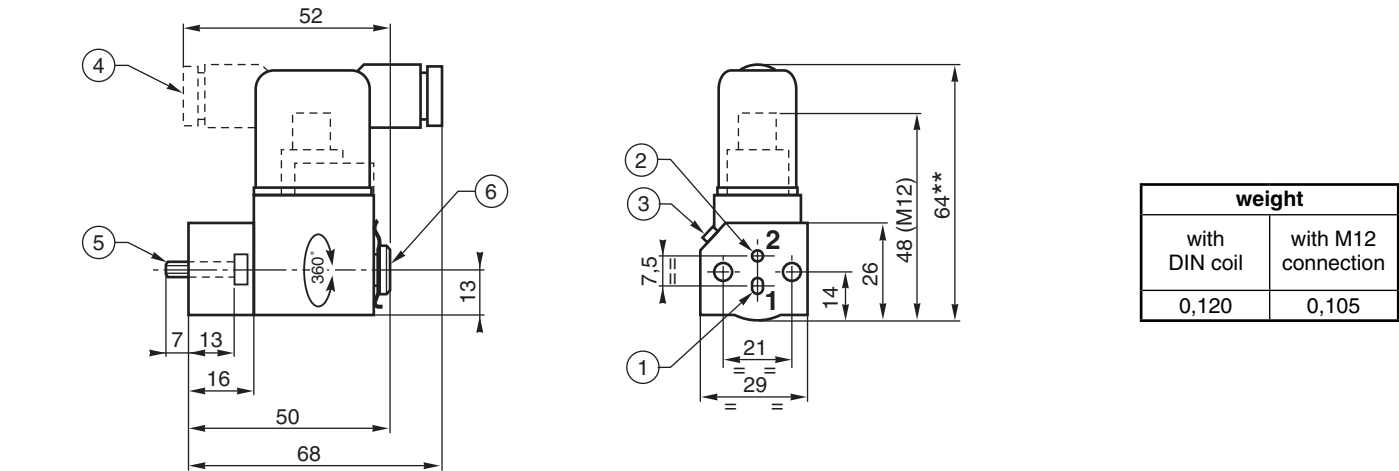

PAD MOUNTING SOLENOID VALVE ON SINGLE INSTANT-FITTING SUBBASE  
Subbase: catalogue number **35300069**

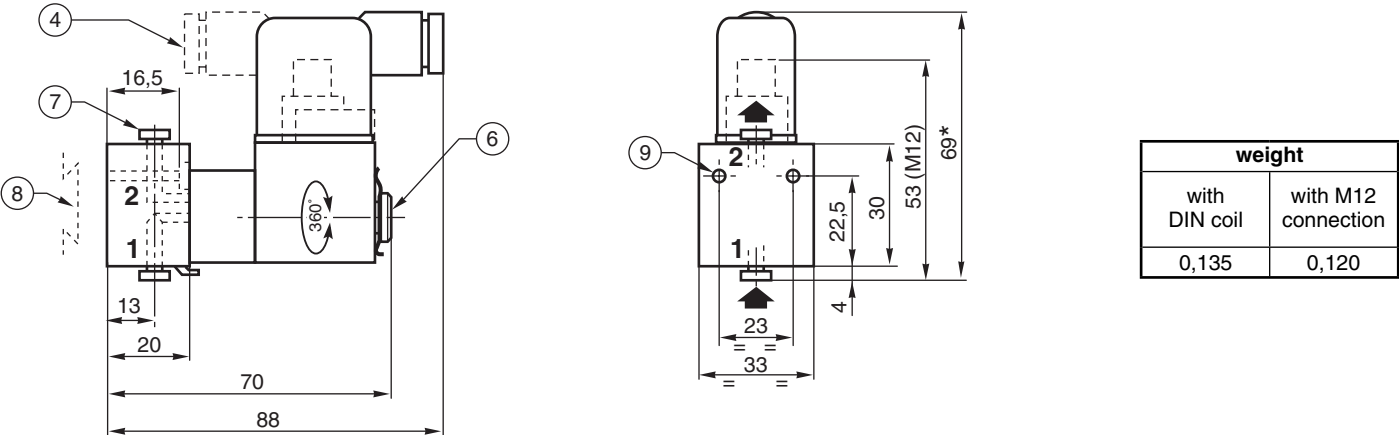



DIMENSIONS (mm), WEIGHTS (kg)

SOLENOID VALVE ON JOINABLE INSTANT-FITTING SUBBASE  
Subbase: catalogue number **35300070**  
Subbases with endpieces: catalogue number **35300071**

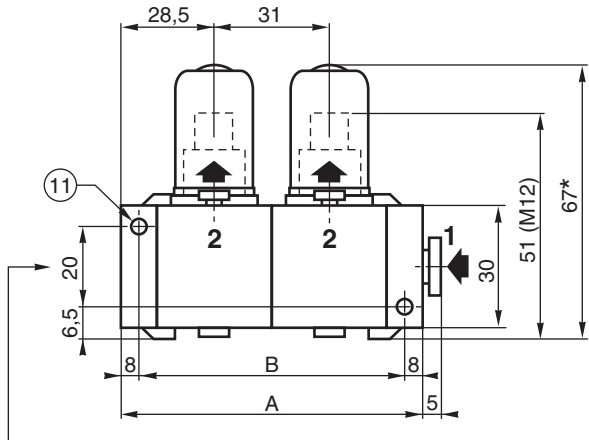
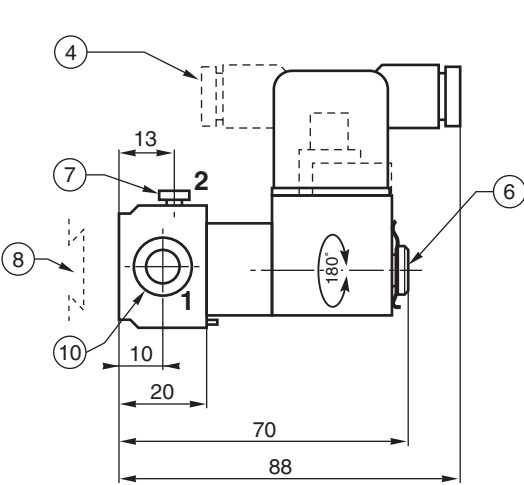

Left-hand pressure intake option or 2 different pressure intakes by procuring the set of two end subbases with end pieces  
Catalogue number: **35300072**  
When mounted on DIN rail, it is recommended to use a securing clip on the end subbases as well as on the central subbase.

Assembly

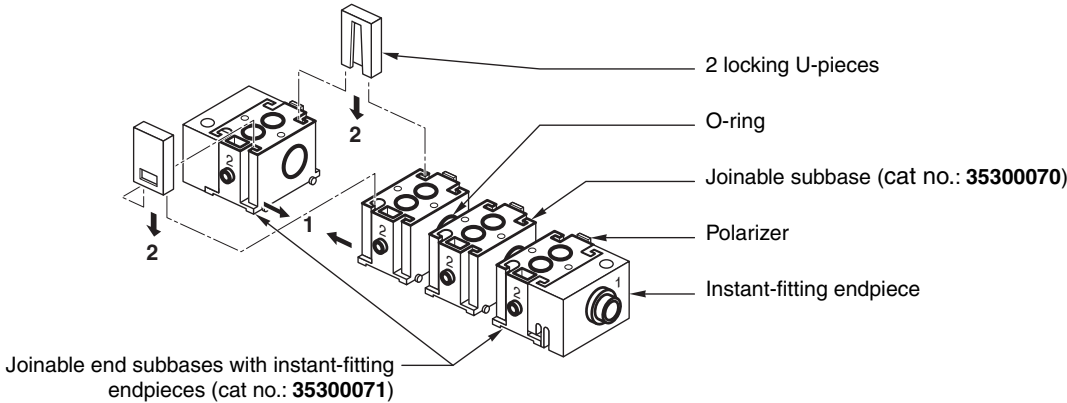

- ① Port 1
- ② Port 2
- ③ Manual operator
- ④ Connector : size 22 rotatable by 180°
- ⑤ Fixing : two CM4x20 screws
- ⑥ Port 3 : connection Ø M5, depth 5,5
- ⑦ Instant-fitting connection for 4 mm OD tube
- ⑧ Adaptable clips
- ⑨ Mounting : two 3,5 dia securing holes, 6,5 dia counter-bores, depth 3,5
- ⑩ Instant-fitting connection for 6 mm OD tube
- ⑪ Mounting : 2 x Ø 4,5

\* + 15 mm for connector removal

number of subbases	A	B	weight with subbases	
			DIN coil	M12 connection
2	88	72	0,295	0,265
3	119	103	0,430	0,385
4	150	134	0,565	0,505
5	181	165	0,700	0,625
6	212	196	0,835	0,745
7	243	227	0,970	0,865
8	274	258	1,105	0,985



## DIMENSIONS (mm), WEIGHTS (kg)

### SOLENOID VALVE MOUNTED ON **SINGLE** SUBBASE

Subbase: catalogue number **35300047**

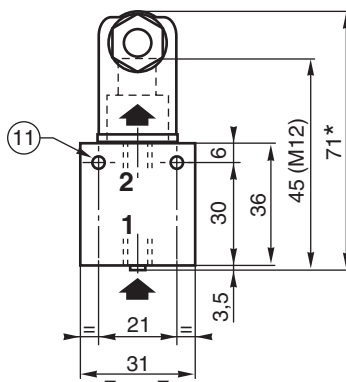
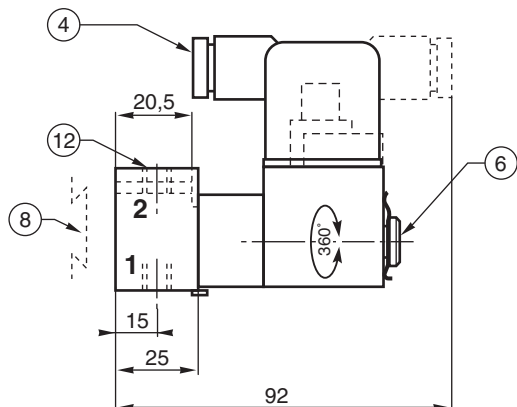

### SOLENOID VALVE MOUNTED ON **JOINABLE** SUBBASE

Subbase: catalogue number **35300048**

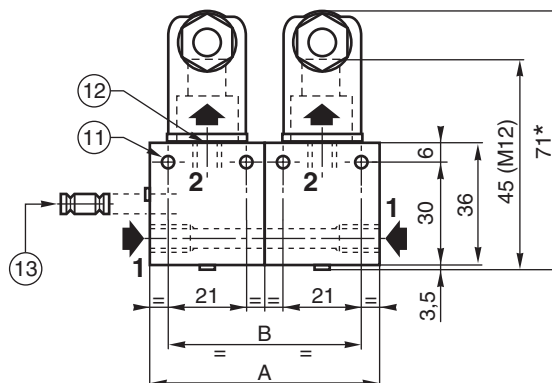
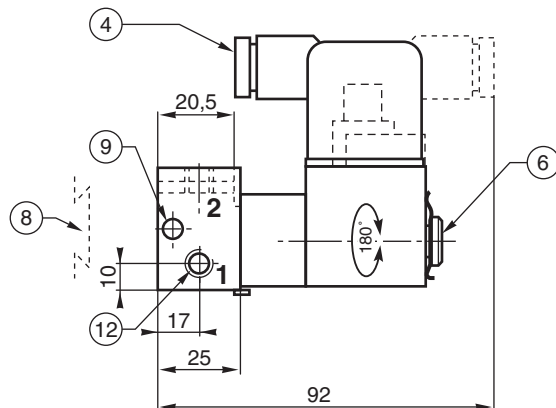

## Assembly

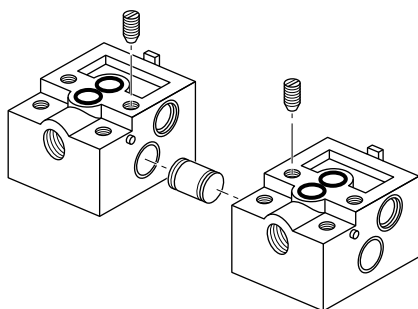

Joinable subbases assembled with adapter locked by sunk set screws

When mounted on DIN rail it is recommended to use a securing clip on each end subbase as well as on the central subbase.

- ④ Connector : size 22 rotatable by 180°
- ⑥ Port 3 : connection Ø M5, depth 5,5
- ⑧ Adaptable clips
- ⑨ Mounting : two 3,5 dia securing holes, 6,5 dia counter-bores, depth 3,5
- ⑪ Fixing : two CM4x20 screws
- ⑫ Ports 1 and 2 : G 1/8
- ⑬ Adapter

\* + 15 mm for connector removal

number of subbases	A	B	weight with subbases	
			DIN coil	M12 connection
2	62	52	0,400	0,370
3	93	83	0,600	0,555
4	124	114	0,800	0,740
5	155	145	1,000	0,925
6	186	176	1,200	1,110
7	217	207	1,400	1,295
8	248	238	1,600	1,480

Subbases delivered with seals, set screws and joining unit for complete assembly.